

LEGEND EXISTING

- GP B GATE POST AND BOLLARD
- INDICATES MAILBOX
- INDICATES SIGN
- TREES
- CATCH BASINS AND MANHOLES
- SANITARY SEWER MANHOLE
- UTILITY POLE AND GUY ANCHOR
- STREET LIGHT
- COMM STRUCTURES
- GAS VALVE
- VALVES, HYDRANTS, WATER METERS
- DITCH LINE
- FENCES
- INDICATES EXISTING CONCRETE
- INDICATES EXISTING ASPHALT
- INDICATES EXISTING GRAVEL

LEGEND PROPOSED

- SAW CUT LINE
- STANDARD CURB & GUTTER
- SIDEWALK
- DRIVEWAY PAY LIMIT
- CROSS SLOPE 1.5% MAX.
(MAX. 2.0% FINISHED SURFACE SLOPE)
(NORMAL SIDEWALK CROSS SLOPE)
- RUNNING SLOPE 7.5% MAX.
(MAX. 8.3% FINISHED SURFACE SLOPE)

STRIP MAP LEGEND

- EXCESS ROW
- PROPOSED ROAD IMPROVEMENTS
- PROPOSED SIDEWALK IMPROVEMENTS
- SIDEWALK EASEMENT NEEDED
- TREES TO BE REMOVED
- PED CROSSING
- RECTANGULAR RAPID-FLASHING BEACON CROSSING (BY OTHERS)

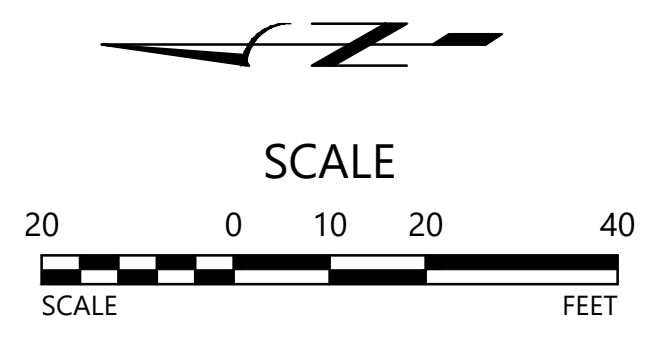

**SW 195TH AVENUE
COUNTY ROAD NO. 2397**

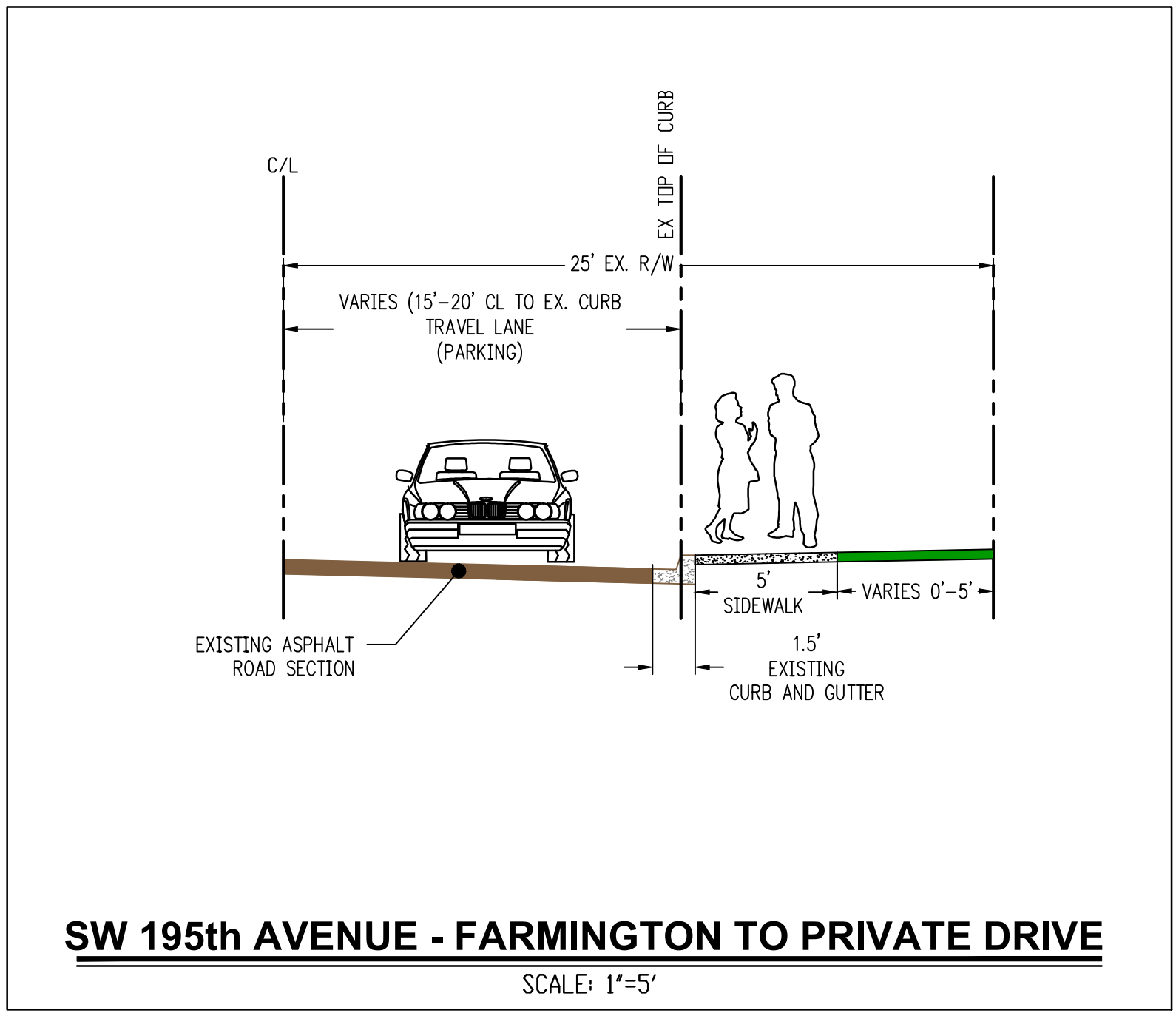
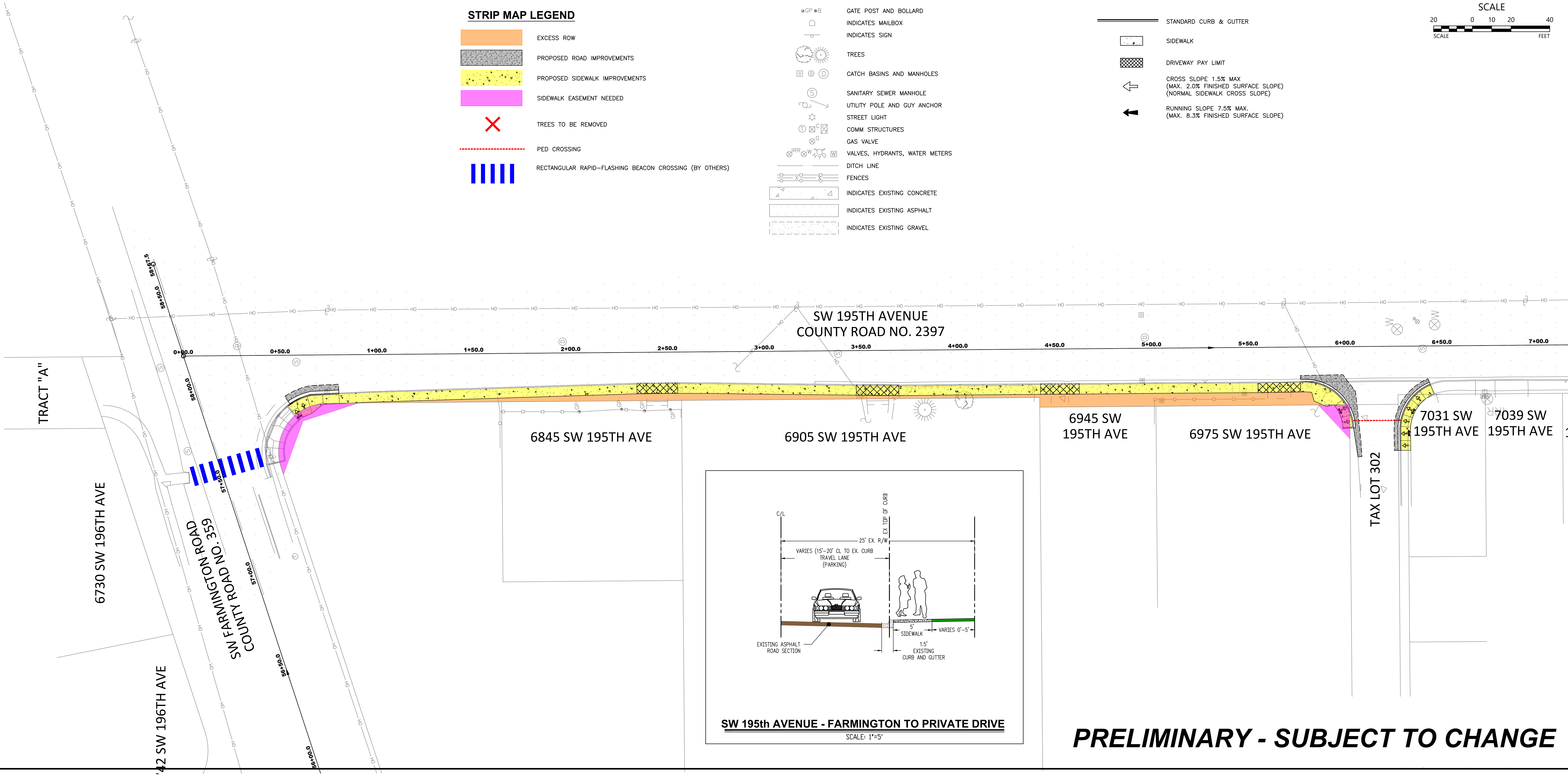

SW 195th AVENUE - FARMINGTON TO PRIVATE DRIVE
SCALE: 1"=5'

PRELIMINARY - SUBJECT TO CHANGE

195TH AVENUE
ROW IMPROVEMENTS
WASHINGTON COUNTY

URMD SIDEWALK
IMPROVEMENTS PROJECT
STRIP MAP EXHIBIT

NO.	DATE	DESCRIPTION

EMERIO
ENGINEERING • SURVEYING • DESIGN
6448 SW FALLBROOK PLACE, SUITE 100
BEAVERTON, OREGON 97008
PHONE: (503) 638-8822
FAX: (503) 638-8822
www.emeriodesign.com

FILE: P:\0725-001 SW 195th Avenue - SW Farmington Road to SW Keena Ct\Map\Exhibits\Open House Strip Map\0725-001_01strip_Layout: COIB (2). Pot Date: 9/22/2022 11:35 PM, by: Alfredo Perez-Lozano