



NW SALTZMAN RD - Laidlaw Road to Bayonne Lane

Western Alignment - Plan



20-2752

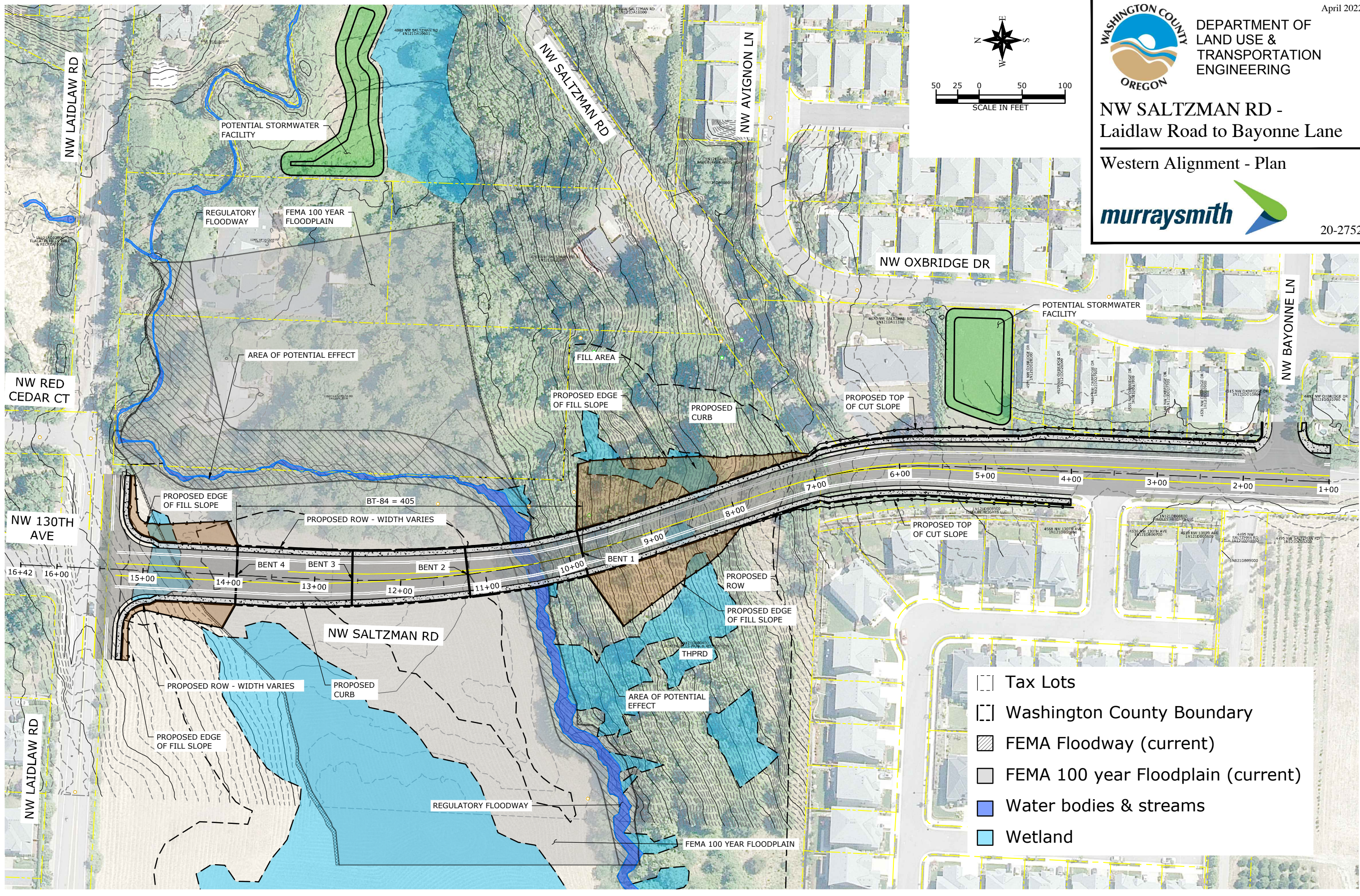
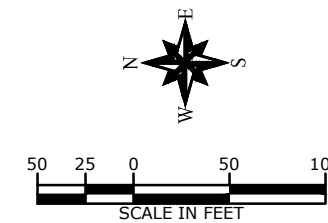

- Tax Lots
- Washington County Boundary
- FEMA Floodway (current)
- FEMA 100 year Floodplain (current)
- Water bodies & streams
- Wetland

C:\PDX_Projects\20_2752 - Wash. County - NW Saltzman Rd Realignment\CAD\Working\ARC\OPEN HOUSE_20-2752-OR-C-WEST_PLAN.dwg ALT 2 4/14/2022 4:12 PM ANGEL CASTRO 23.0s (LMS Tech)